

The real beauty of the DrySnap Under Deck Rain Carrying System is how easy it is to install. Just purchase the DrySnap System and gather these simple tools and materials.

## Tools

- Tape Measure
- Tin Snips
- Step Ladder
- Cordless Screw Gun
- Chalk Line
- Caulk Gun
- Miter Saw or Hand Saw
- Rubber Mallet
- Level
- Leather Gloves
- Eye Protection

## Materials

- Stainless Steel Deck Screws  
2-1/2" Screws w/ Driver - Part# 8417B  
3" Screws w/ Driver - Part# 84179
- Caulk
- Vinyl Flashing
- Gutter and Downspout  
(Standard gutter and downspouts are suggested but not required with the DrySnap system.)  
6-1/2" Gutter Screws w/ Ferrule - Part# 84181
- 1/2" #8 Zip Screws

**Make sure all materials used are compatible with ACQ and CA treated lumber.**



PRIOR TO ANY INSTALLATION, IT IS IMPERATIVE THAT THE INSTALLER INSPECTS THE UNDERSIDE OF THE JOISTS IN SEVERAL LOCATIONS. IF THERE ARE ANY JOISTS THAT ARE WARPED OR IRREGULAR, AND/OR IF THE JOISTS ARE NOT LEVEL OR POSITIVELY SLOPED IN THE DIRECTION OF INTENDED WATER FLOW, THEY WILL NEED TO BE CORRECTED PRIOR TO PROCEEDING WITH INSTRUCTIONS. MINOR IRREGULARITIES MAY BE CORRECTED BY ADDING SHIMS OF THE APPROPRIATE THICKNESS. IN SOME INSTANCES, FURRING STRIPS OR ANGLED RIPPED WOOD MAY NEED TO BE INSTALLED TO CORRECT THE OVERALL SLOPE BEFORE INSTALLING THE DRYSNAP SYSTEM. FAILURE TO ADDRESS THIS WILL LIKELY CAUSE PERFORMANCE ISSUES NOT RELATED TO THE PRODUCT, AND WILL SUBSEQUENTLY VOID THE PRODUCT WARRANTY.

## Install Joist Brackets

1. Make sure your ledger board (main support board attached to house) is properly secured and flashed. There should be a minimum of 8" of flashing out from ledger board (FIG.1-A). If flashing does not extend past the gap between the first two deck boards, install gutter along ledger board after DrySnap system is installed.
2. Mark your chalk line nearest the ledger board. Measure 3-1/2" out from the ledger board on opposite sides of deck, and pop or snap chalk line (FIG.1-B). This mark will be your "center" mark for positioning the joist brackets.
3. Mark your outermost chalk line. Measure 3-1/2" out from the ledger board on opposite sides of deck and pop or snap chalk line (FIG.1-C). This mark will be your "center" mark for positioning the joist brackets.
4. Proceed to snap the middle chalk lines. Beginning with the ledger board side, measure, mark & snap chalk lines every 20" apart (FIG.1-D). Again, this mark will be your "center" mark for positioning the joist brackets. Spacing between rows should not exceed 20", including the last row.
5. Before installing joist brackets, place a level on the joist in several locations to make sure deck is level or pitched toward drainage direction of system. (Inconsistent or bowed joist are covered later in these instructions.)

6. Install first joist bracket by aligning the center of the joist brackets with your chalk line. Start in middle of first joist by fastening bracket with male keystone snap closest to outer perimeter joist (FIG.2). Make sure center of bracket is lined up with chalk line.

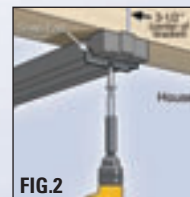

7. **Pitch Spacers** set the pitch to drain water from the system. The first row of brackets requires no spacers. The second row requires one spacer, the third row two spacers and so on... When snapping spacers together, snap side A to side B (FIG.3). Spacers will be located on every joist between the bracket and joist (FIG.4).



8. Locate and install first bracket of each row before continuing installation of each row. **Locating the first bracket is very important!** The bracket snaps must line up in order for panel channels to snap in properly.

Locate first bracket on each row by popping or snapping a chalk line down the first joist. Install brackets leaving screws loose at first. Snap the starter channel into the bracket making sure it is straight (FIG.5), then go back and tighten all screws.



**Note— Make sure not to over tighten screws.**

9. To remove a channel or panel, grab both sides of channel and twist. After unsnapping one or two snaps, slide the rest of starter channel or panel off brackets (FIG.6).

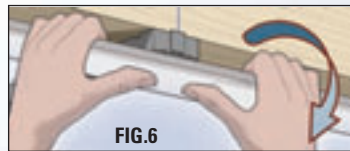

10. **Inconsistent or Bowed Joist.** Install first two panels (steps 13-17). Pour water onto panels to make sure water is draining properly. Continue installing system, one bracket and two panels at a time, using spacers to correct inconsistent pitch.

11. After first bracket of each row is properly located and installed, install entire row of brackets. Brackets snap in place, giving you two free hands to slide spacer under joist and screw bracket in place (FIG.7-A). Due to inconsistency with deck building, wood joists and structure settling, connect the DrySnap joist bracket dove tail connections with a 1/2" #8 zip Phillips head screw (FIG.7-B).

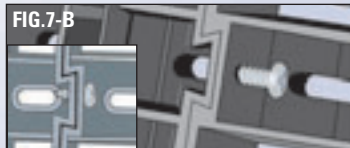

12. At end of bracket run, cut a joist bracket and fasten it to last joist to close system (FIG.8).



### Install Starter Channel & Panels

13. Measure and cut panels and starter channel (length is measured from ledger board to outside edge of last row of joist brackets). Leave 2-1/2" gap from end of panel to beam/gutter fascia board for water to drain (FIG.9).

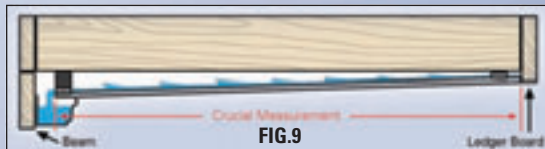

14. At same end where you started installing joist brackets, snap starter channel into joist brackets (FIG.10).



**Very Important—**  
Make sure starter channel and panels snap in completely. Missing a

**snap anywhere in the system will cause a sag in the panels and could result in a leak.**

Leave a temporary 2" gap between ledger board and panel channel for later installation of trim cap.

15. Take a panel and snap it to the starter channel already in place. Make sure flexible flange is in place. At the end of the panel on the gutter side, add bead of caulk, where shown, to prevent water seeping into the channel (FIG.11). Repeat this at every panel connection point on gutter side.

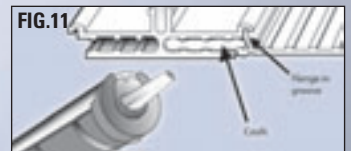

16. Snap panel/channel into bracket (FIG.12).



17. Repeat this process while installing the trim cap as you move across the entire deck (FIG.13).



18. If last panel needs trimming, measure width between last two bracket snaps (FIG.14-A), mark panel with straight edge and trim panel (FIG.14-B). Run a bead of caulk along entire panel and snap panel in place (FIG.14-C).

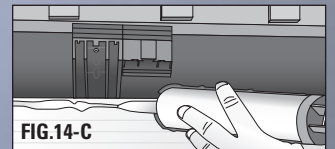

19. If deck frame is even with joist and exposing joist brackets, close in system with treated 1" x 4" wood or pvc trim (FIG.15).



### Install Gutter (optional)

20. Refer to gutter installation guidelines for hanging gutter with DrySnap system.  
**Note— Gutter hangers must be hot dipped or stainless steel fasteners must be used if gutter is attached to ACQ treated lumber. If installing aluminum gutter to treated lumber, use a vinyl flashing barrier between the gutter and the ACQ treated lumber.**

